







EXPLANATORY NOTES:

1242	Indicates Manhattan tax block number.
325.00	Indicates dimension heretofore established and hereby retained.
20'	Indicates roadway and sidewalk treatment dimension heretofore established and hereby retained.
15'	Indicates roadway and sidewalk treatment dimension hereby established.
201.42	Indicates dimension hereby established.
70.0	Indicates elevation hereby established.
	Indicates street line heretofore establishes and hereby retained.
	Indicates street line hereby established.
	Indicates roadway and sidewalk treatment hereby established or heretofore established and hereby retained.
	Indicates roadway and sidewalk treatment heretofore established and hereby eliminated.
	Indicates parks hereby established.
	Indicates tie-in dimension line.
13.31'	Indicates tie-in dimension hereby established.

Elevations shown on the map refer to the datum of the Borough of Manhattan, which is 2.750 feet (0.838 meters) above the U.S.C.&G. Survey datum at Sandy Hook, New Jersey.

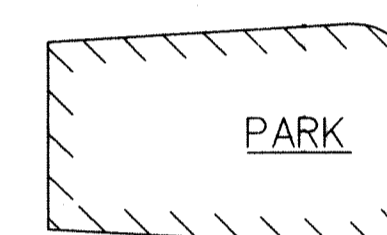
Elevations are taken at top of curb unless otherwise noted. Top of curb is considered to be 7 inches above the adjoining roadway surface, regardless of the height of the actual built curb.

Sidewalk dimensions shown are theoretically established for grade determination purposes only.

All dimensions and elevations shown on the map are in feet unless otherwise noted.

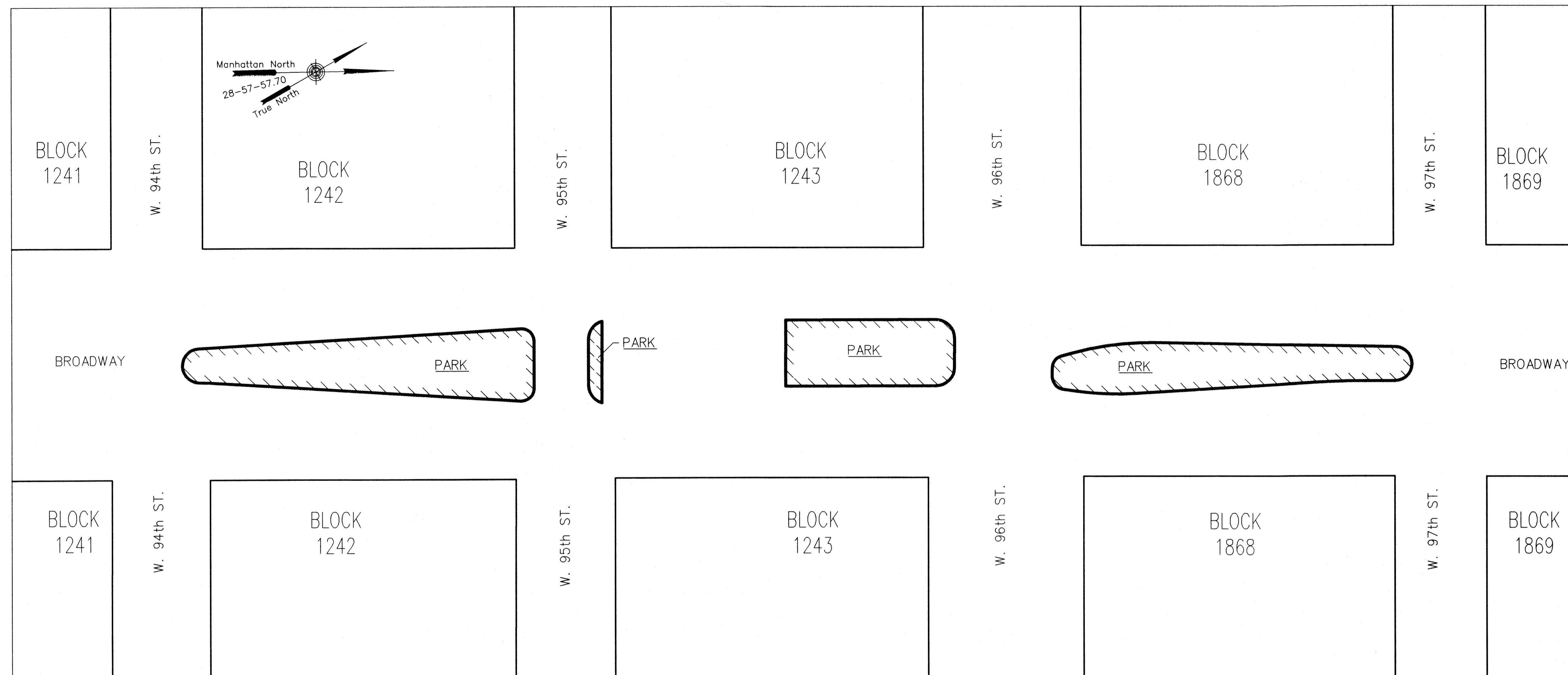

CONTENTS

SHEET 1	TITLE SHEET AND KEY PLAN
SHEET 2	PLAN
SHEET 3	DISCONTINUANCE AND CLOSING MAP

KEY PLAN
NOT TO SCALE

REFERENCE MAPS

ACC NO. 03638
ACC NO. 30240

PREPARED BY: JL
CHECKED BY: MD

GEOMETRY SHOWN ON THIS DRAWING
IS CERTIFIED BY:

LOUIS BERGER & ASSOCIATES, PC



MICHAEL T DUNN, P.E.

I, YVETTE V. GRUEL, SECRETARY OF THE CITY PLANNING COMMISSION, DO HEREBY CERTIFY THAT THIS MAP IS ONE OF EIGHT SIMILAR MAPS APPROVED BY THE CITY PLANNING COMMISSION ON THE 30TH DAY OF NOVEMBER, 2011 (CALENDAR NO. 2), AND SUBSEQUENTLY APPROVED BY THE CITY COUNCIL ON DECEMBER 19, 2011 (RESOLUTION NO. 1183), WHICH ACTION COMPRISED FINAL APPROVAL, AND THAT THIS MAP WAS FILED ON THE DATE OF THIS CERTIFICATION AND WILL TAKE EFFECT ON THE FOLLOWING DAY.

DATE IN NEW YORK: March 9, 2012

Jo P. Manno
SECRETARY OF THE CITY PLANNING COMMISSION

APPROVED FOR
DEPARTMENT OF PARKS AND RECREATION

Adrienne Boncompagni
COMMISSIONER OF PARKS AND RECREATION

Scott M. Stringer
SCOTT M STRINGER
PRESIDENT, BOROUGH OF MANHATTAN

Maria Mikolajczyk
MARIA MIKOLAJCZYK, P.E.
CONSULTING ENGINEER, BOROUGH OF MANHATTAN

10/29/10
DATE

10/29/2010
DATE

CITY OF NEW YORK
OFFICE OF THE BOROUGH PRESIDENT OF MANHATTAN
TOPOGRAPHIC BUREAU
MAP ACC NO. 30240

SHOWING
THE ELIMINATION, DISCONTINUANCE AND CLOSING
OF PORTIONS OF

BROADWAY BETWEEN WEST 94TH STREET
AND WEST 97TH STREET;
THE ESTABLISHMENT OF PARKS

WITHIN
BROADWAY BETWEEN WEST 94TH STREET
AND WEST 97TH STREET;
THE ESTABLISHMENT OF VARIOUS BLOCK
DIMENSIONS AND STREET WIDTHS;

AND
THE ADJUSTMENT OF GRADES NECESSITATED THEREBY

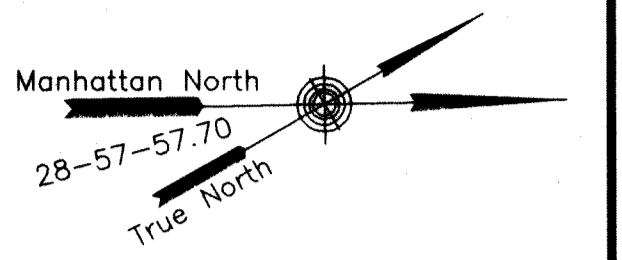

ENGLISH SCALE: 1 INCH = 40 FEET

0 40' 80' 120' 160' 200'

METRIC SCALE: 1 CM = 4.8 M (15.748 FEET)

0 4.8 24 48

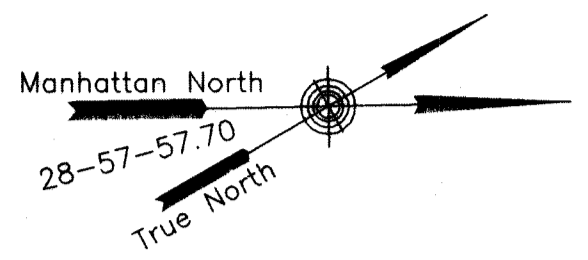

← TO W. 93rd ST.

TO W. 98th ST. →

← TO W. 93rd ST.

TO W. 98th ST. →

BROADWAY

BROADWAY

DISCONTINUANCE AND CLOSING MAP
SCALE 1" = 40'